

WPLED10SW

10 Watt Surface mount or Junction Box LED Wallpack. Equivalent to 70W HPS. IESNA Full Cutoff, Fully Shielded optics. Mount at 7-10'. 5 year warranty.

Color: White

Weight: 3.5 lbs

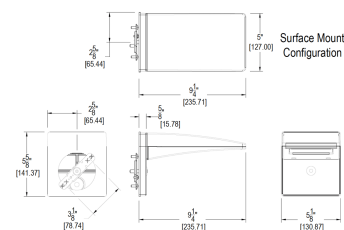

LED Info

Watts: 10W
 Color Temp: 5000K (Cool)
 Color Accuracy: 92
 L70 Lifespan: 100000
 LM79 Lumens: 547
 Efficacy: 41 LPW

Driver Info

Type: Constant Current
 120V: 0.21 A
 208V: 0.14 A
 240V: 0.12 A
 277V: N/A
 Input Watts: 13W
 Efficiency: 76%

Technical Specifications

UL Listing:

Suitable for Wet Locations as a Downlight. Suitable for Damp Locations as an Uplight. Wall Mount only. Suitable for Mounting within 4ft. of ground.

Lumen Maintenance:

The LED will deliver 70% of its initial lumens at 100,000 hours of operation.

Finish:

Chip and fade resistant polyester powder coat finish.

Color Stability:

RAB LEDs exceed industry standards for chromatic stability.

Color Uniformity:

RAB's range of CCT (Correlated color temperature) follows the guidelines of the American National Standard for Specifications for the Chromaticity of Solid State Lighting (SSL) Products, ANSI C78.377-2008.

Cold Weather Starting:

The minimum starting temperature is -40°F/-40°C

Ambient Temperature:

Suitable for use in 40°C (104°F) ambient temperatures

Fixture Efficacy:

41 Lumens per Watt

Color Accuracy:

92 CRI

Color Temperature (Nominal CCT):

5000K

Driver:

Multi-chip 10W high output long life LED Driver Constant Current, Class II, 120V-240V, 50/60 Hz, 350mA

Thermal Management:

Cast aluminum Thermal Management system for optimal heat sinking. The LPACK is designed for cool operation, most efficient output and maximum LED life by minimizing LED junction temperature.

Housing:

Precision die cast aluminum housing, lens frame.

Mounting:

Surface mount.

California Title 24:

LPACK complies with California Title 24 building and electrical codes.

Green Technology:

RAB LEDs are Mercury, Arsenic and UV free.

Patents:

The LPACK design is protected under patents pending in the U.S., Canada, China, Taiwan and Mexico.

Dark Sky Approved:

The International Dark Sky Association has approved this product as a full cutoff, fully shielded luminaire.

For use on LEED Buildings:

IDA Dark Sky Approval means that this fixture can be used to achieve LEED Credits for Light Pollution Reduction.

WPLED10SW - continued

IESNA LM-79 & IESNA LM-80 Testing:

RAB LED luminaires have been tested by an independent laboratory in accordance with IESNA LM-79 and 80, and have received the Department of Energy "Lighting Facts" label.

Gaskets:

High Temperature Silicone

Warranty:

RAB LED fixtures give you peace of mind because both the fixture and driver components are backed by RAB's 5 Year Warranty. For more information,

Equivalency:

The WPLED10 is Equivalent in delivered lumens to a 70W Metal Halide Wallpack.

HID Replacement Range:

The WPLED10 can be used to replace 35-100W Metal Halide Wallpacks based on delivered lumens.